

LEGEND

Existing trees to be retained

Existing palms to be removed

Proposed tree plantings

Proposed shrub plantings

Proposed groundcover plantings

Concrete driveway / path pavement

Non slip tiles pavement

Proposed garden bed

Proposed turf area

Timber garden edge

**SPECIFICATION NOTES**

**PLANTING MATERIALS**

**Planting Mix:**

Imported planting mix to planting beds is to comprise an approved soil mix of:

- 60% Soil mix (75% coarse sand and 25% blacksoil)
- 10% Mushroom compost
- 10% Composted sawdust
- 10% Pine bark fines
- 10% Composted manure

**Mulch:**

Mulch shall mean hardwood (25mm grade), free from material derived from Privet, Willow, Poplar, Coral trees, or other noxious weeds. Any mulch exceeding the 25mm grade shall be rejected / removed from the site. Graded hardwood mulch to be supplied by Australian Native Landscapes Pty Ltd Phone (02) 9450 1444, or approved equivalent.

**Plant Material:**

All plant material must be true to the species. No substitutes will be allowed. All plants shall be free of fungus and insect damage. All plants shall be healthy, well shaped, not soft or force grown and not root bound.

Plants are available from **Andreasens Green** wholesale nursery, contact Darren (02) 8777 4713, email darren@andreasengreen.com.au or approved equivalent.

**Turfed areas:**

All new turfed areas are to be selected weed free Soft Leaf Buffalo. Turf shall be laid neatly butted with staggered joints, flush with adjacent surfaces and have even running falls to all drainage points. All new turfed area shall have a minimum 150mm depth of weed free top soil, placed and levelled prior to turfing.

**PREPARATION AND HARDWORKS**

**Excavating for Spot Planting**

To planting areas, excavate a hole for each plant large enough to provide not less than twice the depth and twice the diameter than the root ball of species to be planted.

**Staking**

Use durable hardwood, straight, free from knots or twists, pointed at one end. Drive stakes into the ground a minimum one third of their length, avoiding damage to the root system.

- 75 Litre trees in 2 x 38x38x1800mm Hardwood Stake with double Nylon tie

**TIES:** Provide a 50mm wide Nylon webbing tie per stake, fixed securely to the stakes, one tie at half the height of the main stem and the other as necessary to stabilise the plant.

**Timber Edge**

**MATERIAL:** Timber edging shall consist of:

Edging: 100 x 50mm hardwood

Pegs: 50 x 50 x 400mm hardwood.

Fastenings: to be 75x3.75mm diam. galvanised nails

**INSTALLATION:** Setout alignment of timber edges on site for approval of Superintendent. Excavate to approved alignment and place edge band within trench to confirm peg locations. Install pegs and affix timber edge in accordance with details. All timber edging to finish flush with adjoining turf.

**MAINTENANCE / PLANT ESTABLISHMENT**

- Landscape Contractors to provide 12 months for maintenance / plant establishment period. Carry out recurrent works of a maintenance nature including, but not limited to, watering, mowing, weeding, rubbish removal, fertilising, pest and disease control, returfing, staking and tying, replanting, cultivating, pruning, hedge clipping, top dressing, and keeping the site neat and tidy.

**NOTE:**

- All finished levels are to be verified by Contractor on site.
- All landscape works be in strict accordance with Council's landscape code and guidelines
- This plan to be used in conjunction with all other submitted architectural, hydraulics and engineering drawing where applicable.

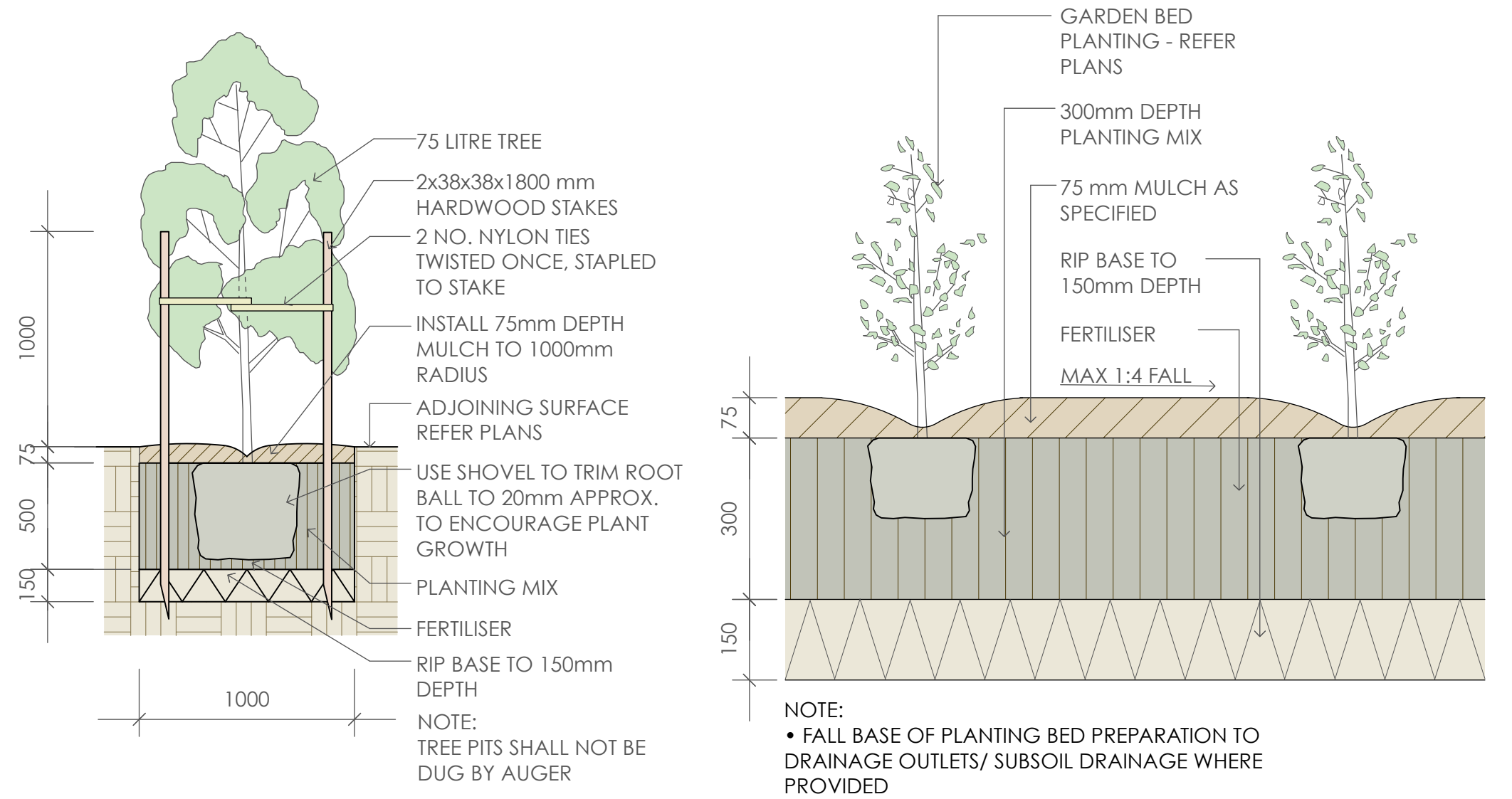
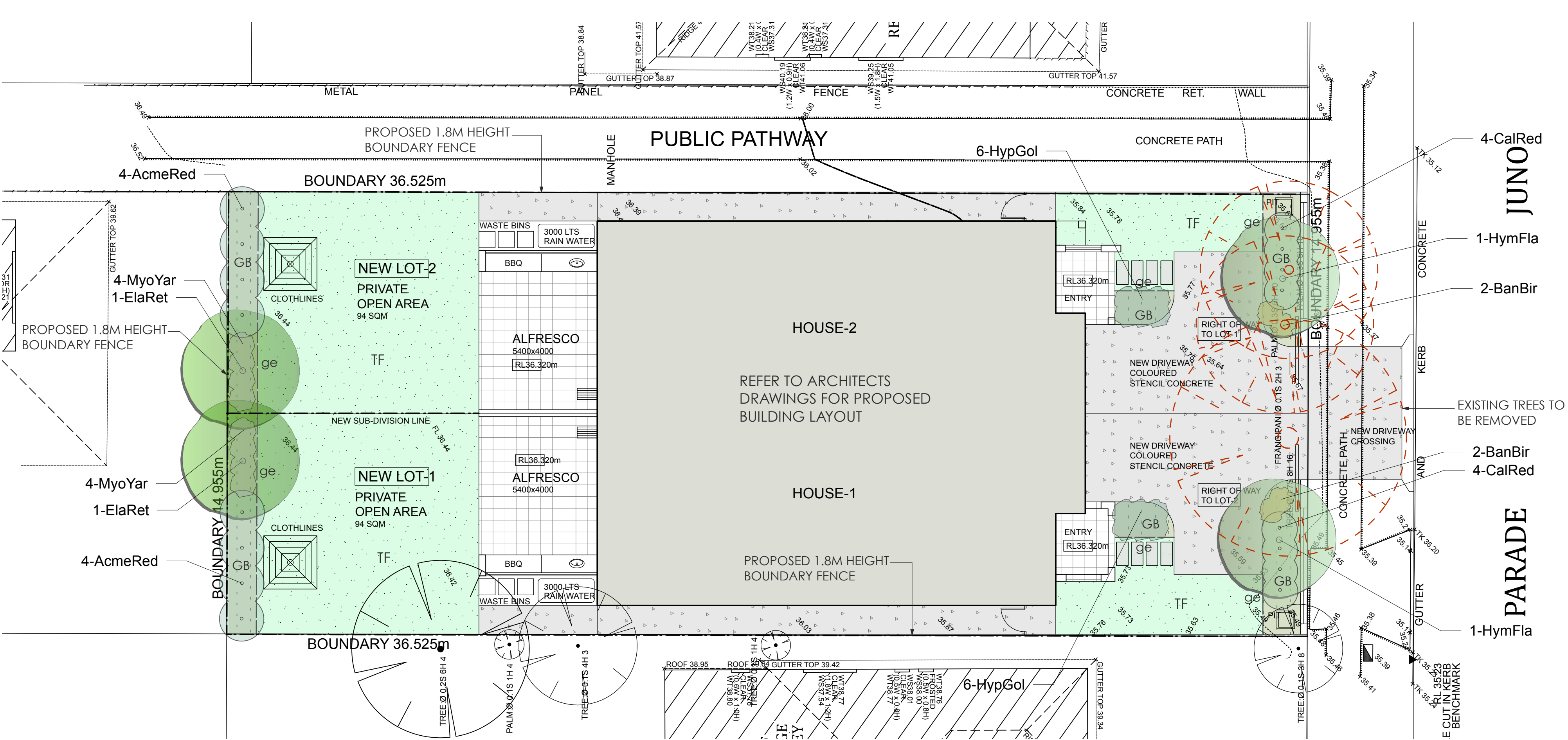

1 75 Litre Tree Planting  
scale 1:25

2 Planting Bed Detail  
scale 1:10

GENERAL NOTES: 1. Do not scale of drawings. Follow written dimensions. If in doubt obtain written advice from the Superintendent. 2. Verify all dimensions on site. 3. Refer to legend for all symbol and code keys. 4. Read in conjunction with the specifications 5. Read in conjunction with all associated drawings				DESIGNED: GD	PREPARED FOR:  D+C CONSORTIUM PTY LTD	PREPARED BY:  <div><div>Greenland Design Pty Ltd ABN 73 139 152 855 Registered Landsc. Architect: Bao Ly Coca Hills NSW 2171 T: 0403 164 198 E: gd@greenlanddesign.com.au</div></div>	PROJECT:  <b>PROPOSED DUAL OCCUPANCY</b>	DRAWING TITLE:  <b>Landscape Plan</b>	DATE:  <b>MAY 2025</b>		
C B A	REVISIONS FOR DA FOR DA	CL CL CL	06.05.25 26.02.25 20.01.25				DRAWN:  CL			SCALE: 1:200 @ A3 1:100 @ A1	ISSUE:  <b>C</b>
ISSUE	AMENDMENT	DRAWN	DATE						PROJECT ADDRESS:  NO. 88 JUNO PARADE GREENACRE	<div></div>	